

DETAIL A

Note: when ordering, it is up to the user to determine the necessary diameter of the tool to achieve the desired fit.

Table II
Cross Reference Table

Nominal Hole Diam (in)	Customer specified manufactured diam range (in)
(5/32)	.150/.162
(11/64)	.163/.179
(3/16)	.180/.195
(13/64)	.196/.210
(7/32)	.211/.227
(15/64)	.228/.240
(1/4)	.241/.258
(17/64)	.259/.273
(9/32)	.274/.288
(19/64)	.289/.305
(5/16)	.306/.320
(21/64)	.321/.335
(11/32)	.336/.352
(23/64)	.353/.365
(3/8)	.366/.384
(25/64)	.385/.397
(7/16)	.398/.414
(27/64)	.415/.429

FUNCTION OF TOOL:

=> USED TO TEMPORARILY CLAMP & ALIGN.

TOOL ORDERING CODE:

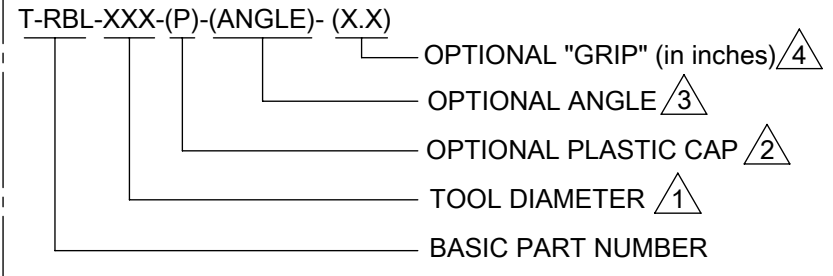

- 1** Customer DIAMETER requirements: TOOL DIAMETER is called out as a 3 PLACE number (XXX). The tool is manufactured to the specified diameter and the tolerance is +.000/- .002 in.
- 2** Optional PLASTIC CAP callout: Standard tool configuration is WITHOUT the plastic cap, and the tool will be provided without plastic cap if not called out. Note: Tools without plastic cap will have anodized Aluminum end cap.
- 3** Optional ANGLE callout: Standard tool configuration is the "ANGLE" on clamping feet = 180°, and will be provided if no ANGLE is called out. If the tool is to be used to clamp in a c'sink hole, or is to be used in other special requirements, then specify the desired angle (see detail view A) in the "(ANGLE)" space located in the part number (see example tool code below).
- 4** GRIP (X.X) callout: Standard stroke length in 1.5 in. GRIP is called out as the max grip (X.X) of the tool. Tool grip range is max grip minus 1.5 in. (see example tool code below).

EXAMPLE TOOL CODE:

- T-RBL-249-1.5**
=> Tool manufactured diameter will be between φ 0.249 +.000/- .002 in. for nominal hole diameter of φ 1/4".
=> Tool WILL NOT have a plastic cap.
=> Tool's grip range will be from 1.5 inch to 0.0 inch.
=> Angle on feet (see detail view A) will be 180°.
- T-RBL-255-P-1.5**
=> Tool manufactured diameter will be between φ 0.255 +.000/- .002 in. for custom hole diameter.
=> Tool WILL have a plastic cap.
=> Tool's grip range will be from 1.5 inch to 0.0 inch.
=> Angle on feet (see detail view A) will be 180°.
- T-RBL-.245-120-2.5**
=> Tool manufactured diameter will be between φ 0.245 +.000/- .002 in. for custom hole diameter.
=> Tool WILL NOT have a plastic cap.
=> Clamping feet will be made to a 120 degree angle (see detail view A).
=> Tool's grip range will be from 2.5 inch to 1.0 inch.

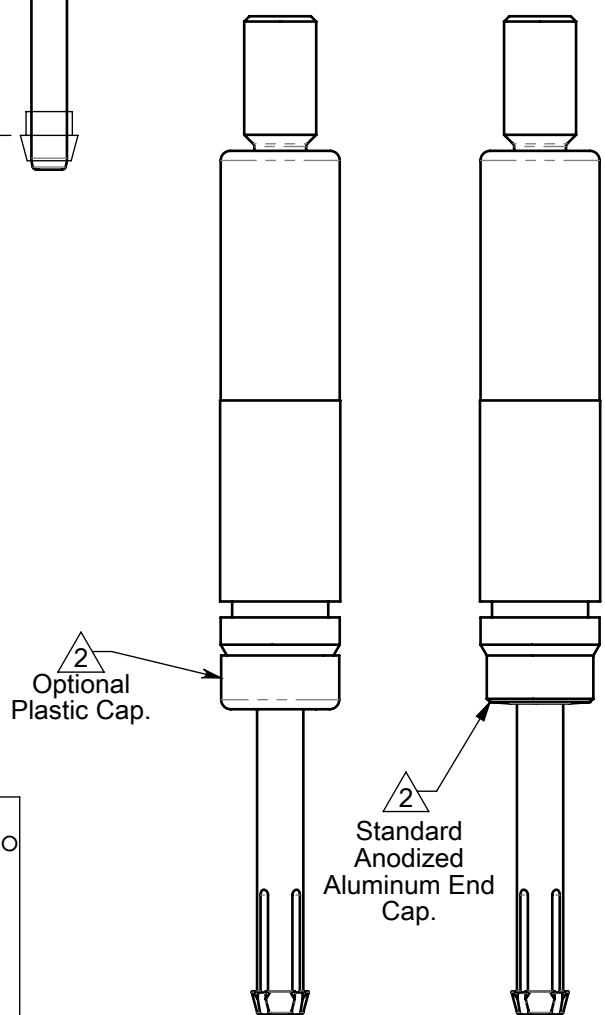

NOTES:

EXCEPT FOR USE EXPRESSLY GRANTED, INFORMATION DISCLOSED HEREON IS CONFIDENTIAL AND ALL PATENT, PROPRIETARY, SALES, MANUFACTURING, USE, DESIGN, AND REPRODUCTION RIGHTS ARE RESERVED BY CENTRIX, Inc.

25329 74th Ave South Kent, WA 98032
Ph: 253-872-4773
www.CENTRIX-LLC.com

CENTRIX LLC

RBL-XX-(P)-(ANGLE)-(X.X)

TEMPORARY FASTENERS

PATENT PENDING

REV -

SHEET 1 OF 1
USAGE AND ORDERING SHEET

PATENT PENDING

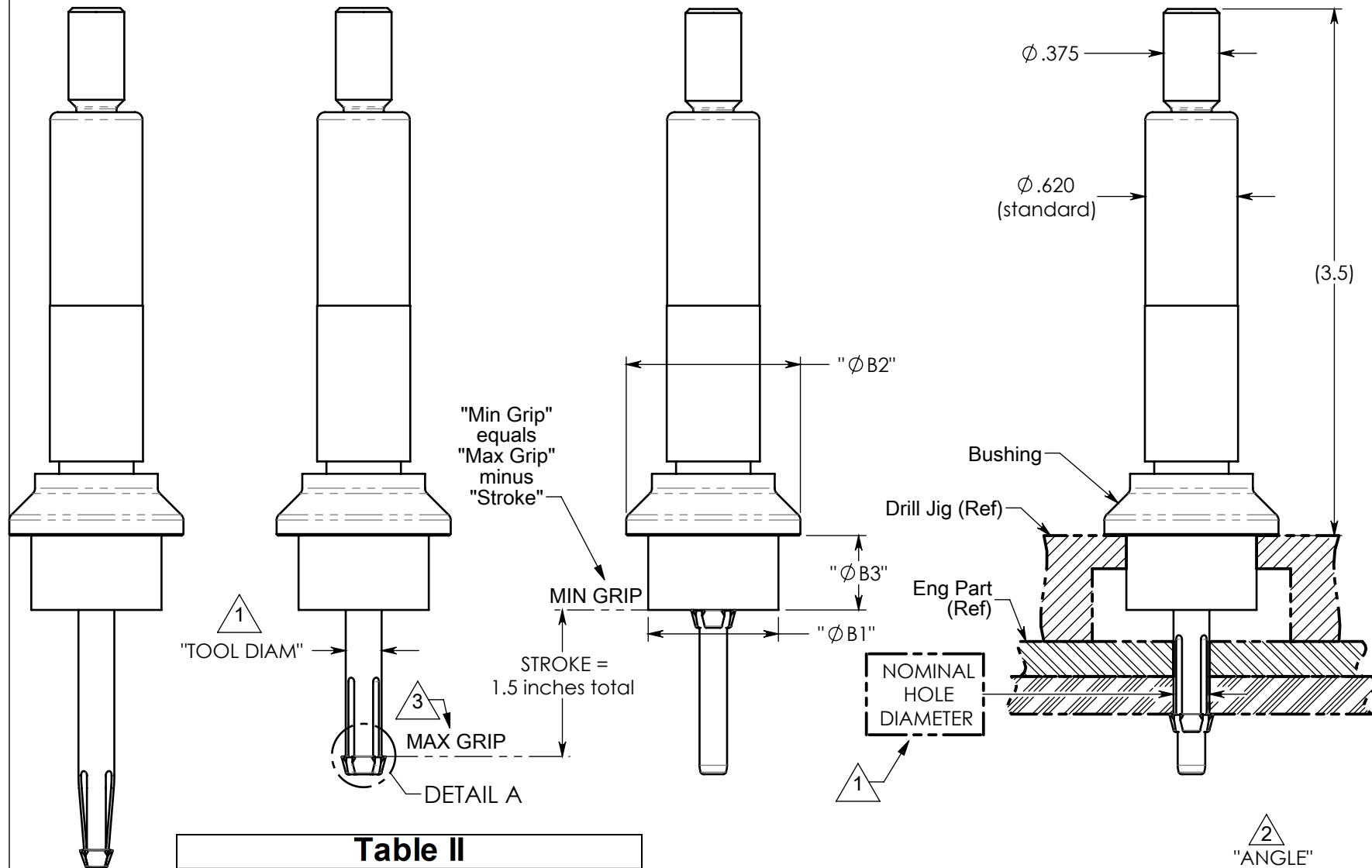

Table II

Cross Reference Table	
Nominal Hole Diam (in)	Customer specified manufactured diam range (in)
(5/32)	.150/.162
(11/64)	.163/.179
(3/16)	.180/.195
(13/64)	.196/.210
(7/32)	.211/.227
(15/64)	.228/.240
(1/4)	.241/.258
(17/64)	.259/.273
(9/32)	.274/.288
(19/64)	.289/.305
(5/16)	.306/.320
(21/64)	.321/.335
(11/32)	.336/.352
(23/64)	.353/.365
(3/8)	.366/.384
(25/64)	.385/.397
(7/16)	.398/.414
(27/64)	.415/.429

Table III LOCK COLLAR CROSS REFERENCE TABLE	
LOCK COLLAR SERIES	B2 +0.00 -0.01
21000	0.57
22000	1.17
23000	1.42
24000	1.67
25000	2.22

All B Dimensions and Tolerances:

B1 in 0.001" increments; tolerances +.000/-0.001

B2 in .01" increments; tolerances +.00/-0.01 (see Table III)

B3 in .1 increments; tolerances +.0/-0.1

"2" "ANGLE" for special requirements (181° shown)

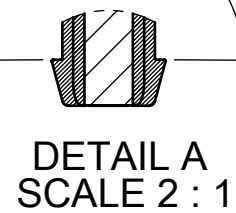

Note: when ordering, don't forget to order a tool diameter smaller than the lower spec limit on the hole. It is up to the user to determine the necessary diameter of the tool to achieve the desired fit.

FUNCTION OF TOOL:

=> USED TO TEMPORARILY CLAMP & ALIGN.

TOOL ORDERING CODE:

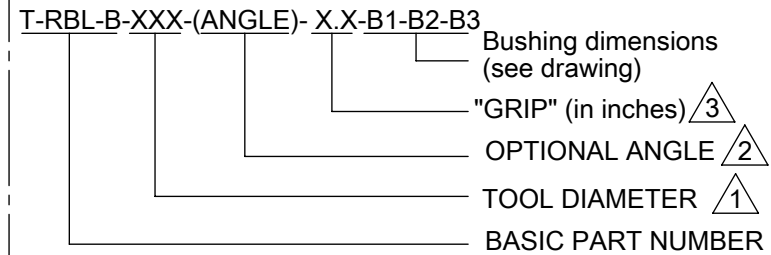

1 Customer DIAMETER requirements: TOOL DIAMETER is called out as a 3 PLACE number (XXX). The tool is manufactured to the specified diameter and the tolerance is +.000/-0.002 in.

2 Optional ANGLE callout: Standard tool configuration is the "ANGLE" on clamping feet = 180°, and will be provided if no ANGLE is called out. If the tool is to be used to clamp in a c'sink hole, or is to be used in other special requirements, then specify the desired angle (see detail view A) in the "(ANGLE)" space located in the part number (see example tool code below).

3 GRIP (X.X) callout: Standard stroke length in 1.5 in. GRIP is called out as the max grip (X.X) of the tool. Tool grip range is max grip minus 1.5 in. (see example tool code below).

EXAMPLE TOOL CODE:

T-RBL-B-249-1.5-.375-.57-.5
=> Tool manufactured diameter will be between ϕ 0.249 +.000/-0.002 in. for nominal hole diameter of ϕ 1/4".
=> Angle on feet (see detail view A) will be 180° (default).
=> Tool's grip range will be from 1.5 inch to 0.0 inch.
=> Bushing dimensions B1=.375, B2=.57, B3=.5

T-RBL-B-.252-5.0-5-.75-1.0
=> Tool manufactured diameter will be between ϕ 0.252 +.000/-0.002 in. for custom hole diameter.
=> Angle on feet (see detail view A) will be 180° (default).
=> Tool's grip range will be from 5.0 inch to 3.5 inch.
=> Bushing dimensions B1=.500, B2=.75, B3=1.0

T-RBL-B-.252-130-5.0-5-.75-1.0
=> Tool manufactured diameter will be between ϕ 0.252 +.000/-0.002 in. for custom hole diameter.
=> Angle on feet (see detail view A) will be 130°.
=> Tool's grip range will be from 5.0 inch to 3.5 inch.
=> Bushing dimensions B1=.500, B2=.75, B3=1.0

PATENT PENDING

25329 74th Ave South Kent, WA 98032
Ph: 253-872-4773
www.CENTRIX-LLC.com

CENTRIX LLC

RBL-B-XXX-(ANGLE)-(X.X)

TEMPORARY FASTENERS

NOTES:

EXCEPT FOR USES EXPRESSLY GRANTED, INFORMATION DISCLOSED HEREON IS CONFIDENTIAL AND ALL PATENT, PROPRIETARY, SALES, MANUFACTURING, USE, DESIGN, AND REPRODUCTION RIGHTS ARE RESERVED BY CENTRIX, Inc.

PATENT PENDING

REV -
SHEET 1 OF 1
USAGE AND ORDERING SHEET